

PROPRIETARY RIGHTS ARE CLAIMED FOR THE MATERIAL DISCLOSED IN THIS DRAWING.

LTR	REVISIONS	DATE

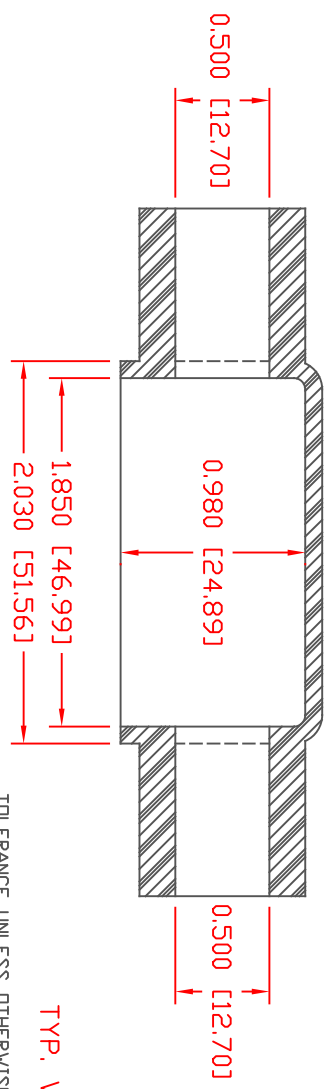
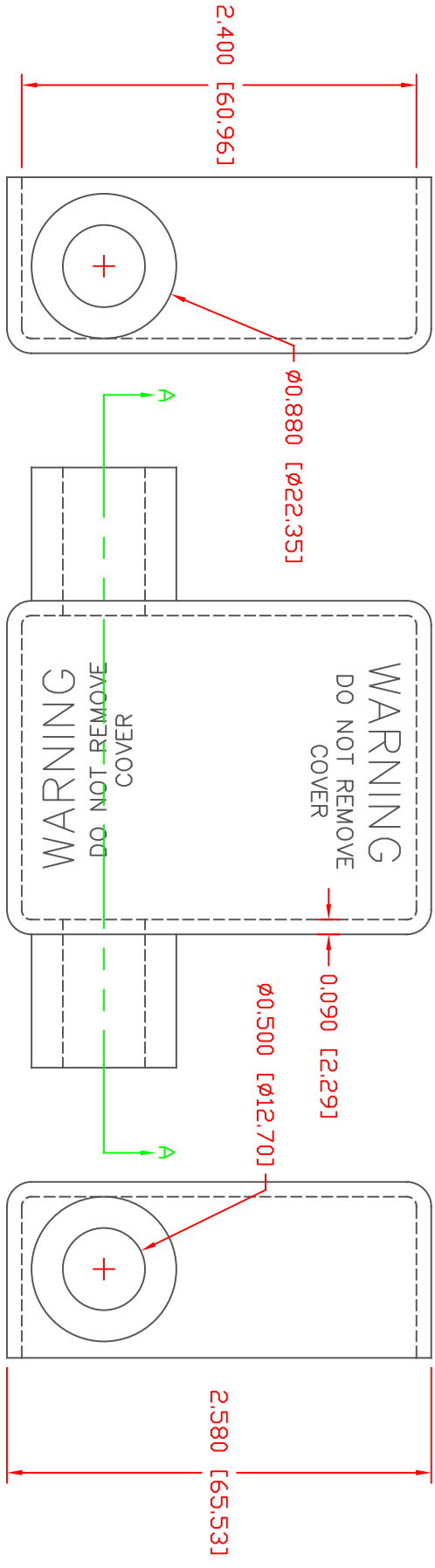

TYP. WALL THICKNESS = 2.3

SECTION A-A

MATERIAL PART NO:  
 MATERIAL:  
 VENDOR PART NO:  
 SHORE DUREMETER:  
 SPECIFIC GRAVITY:  
 ULT. ELONGATION %:  
 MELTING TEMP:  
 BRITTLE TEMP:  
 Tensile Strength PSI:  
 Dielectric Strength, v./mil  
 U.L. Rating:

1101650114  
 PVC  
 9812-65-BLACK  
 1/4" 10 SEC. 65  
 1.34  
 400  
 315-335 F [157-168 C]  
 -54 F [-48 C]  
 1550 PSI  
 453  
 V2

TOLERANCE UNLESS OTHERWISE SPECIFIED: ±0.30/±0.8mm  
 RADIAL DIAMETERS TO BE MEASURED OVER MANDRELS,  
 RING GAGES OR PIN GAGES OF SUITABLE SIZE



VTE Incorporated  
 5437 Robinson Road, P.O. Box 790  
 Pellston, Michigan 49769  
 Telephone: 1-800-527-9256, 231-539-8000  
 FAX: 231-539-0914

REF:	DATE:	DRN BY:	JC	WEIGHT:
	4-6-98	CHK'D BY:		078 LBS. / 35.5 G.
TITLE:	BATTERY CABLE BOOT			
MATERIAL:	PVC	PART NO.	DUAL ENTRY	
COLOR:	DRG CLASS	500D7V14		